

MODEL DVP75C

7.5 HP P.D. CENTRAL VACUUM

LARGE, EASY ACCESS
FILTER SERVICE DOOR

SUPER EFFICIENT
FILTRATION

FILTER CONDITION
INDICATOR GAUGE

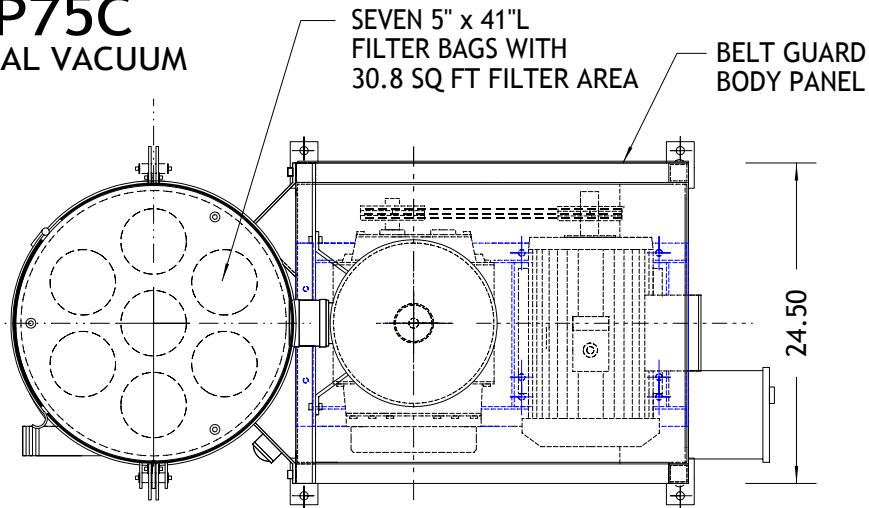

SPECIFICATIONS:

7.5 HP TEFC MOTOR (VOLTAGE TO SUIT)
170 ICFM @ 12" Hg. (168" WG)
22.8 SF INLINE FILTER
82 dBa @ 3FT NOISE LEVEL
18.3 US GAL. DIRT CAPACITY
32.1 SF P84 FILTER BAGS
99.997% @ 0.4 MICRON EFFICIENT
WEIGHT 725 LBS

INTERNAL MANUAL
FILTER BAG
SHAKER

INLINE
FILTER
WITH
CONDITION
INDICATOR

OVERHEAD
CRANE LIFT
LUGS

2" NPT
INLET WITH
INTERNAL
WEAR STRIP

18.3 US GAL
STORAGE DRUM

HEAVY DUTY
MECHANICAL LIFTER

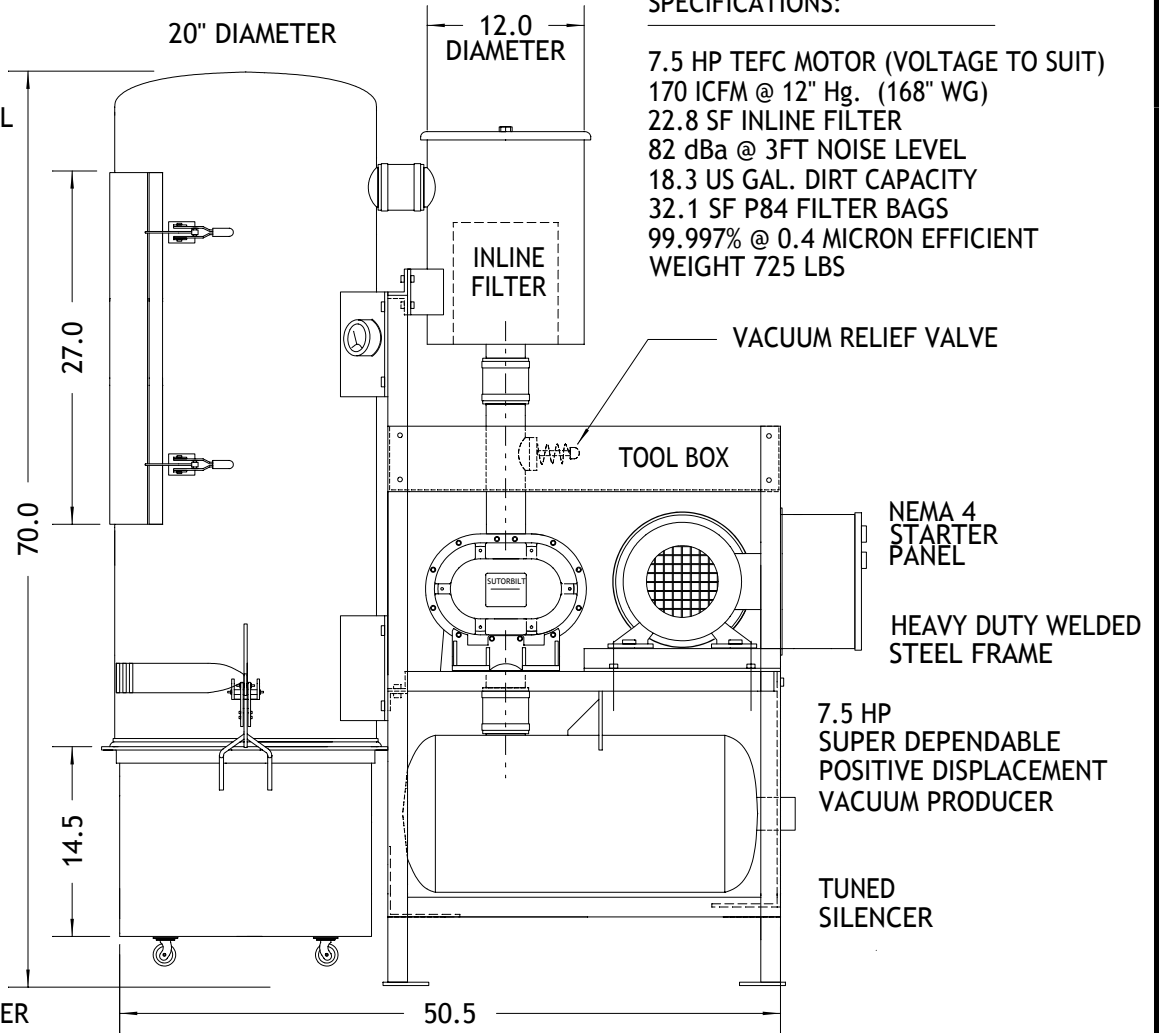

C:\DCAD\DWGS\DX\20PD_DWGS\DVP75C.DWG KRW MAR 02

			DATE:	MAR 02	NORTHWIND AIR SYSTEMS BRAMPTON, ONTARIO
			DRAWN BY:	KRW	
1			SCALE:	N.T.S.	DuroVac CONTINUOUS DUTY DVP75C 7.5 HP VACUUM
0	MAR 02	ISSUED FOR REVIEW	DRAWING No.	Rev.	
No.	DATE	REVISIONS	D2003064	00	